



SKYLO

DUAL FLUSH VALVE

AUTO FLUSH



WARNING

We shall not be responsible or liable for any failure of, or damage to, this plumbing product caused by the use of chlorine/bleach cleaners or related products added to the tank water. Use of such products will void the warranty and may result in product failure, possibly causing property damage. Do not over tighten plastic nuts and always turn off water supply when installing / removing toilet cistern parts.

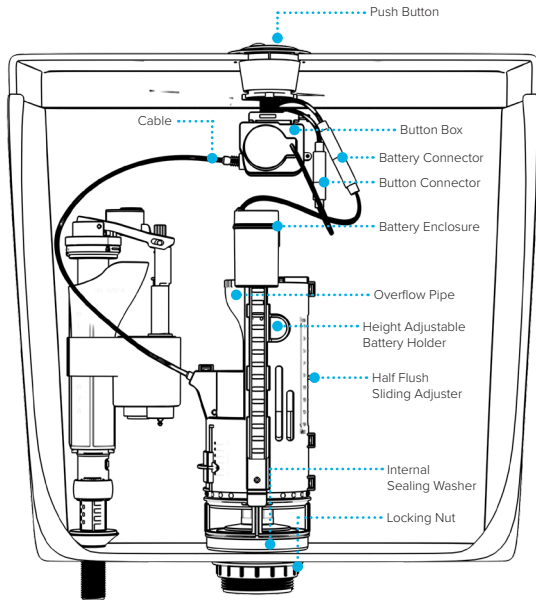

Please note: Save this instruction sheet for future reference
IMPORTANT: DO NOT use plumber's putty to seal this fitting

UK - Units 1-3 Capitol Trading Park, Kirkby Bank Road,
Knowsley Industrial Estate, Liverpool, L33 7SY
EU - Authorised Rep Compliance Ltd., GroundFloor,
71 Lower Baggot Street, Dublin, D02 P593, Ireland.

For more information please contact us:
Tel: 0151 546 0531 E-mail: sales@vivasanitary.co.uk

INSTALLATION INSTRUCTIONS

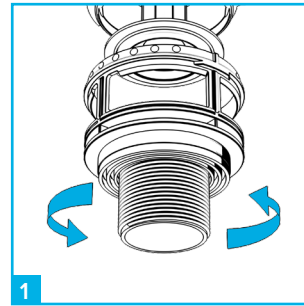

Choose the correct cradle size for the installation, 1 1/2" (factory fitted) or 2". To remove cradle twist and pull from flush valve, to connect reverse procedure.

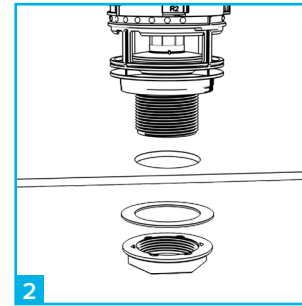

Insert the flush valve into the water tank and tighten to the tank using the washer and nut.

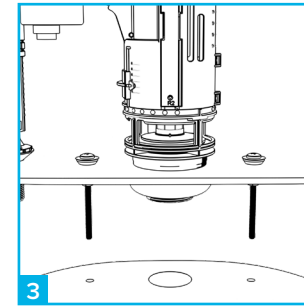

Replace or refit the doughnut washer and fasten the tank to the toilet with the bolt through kit.

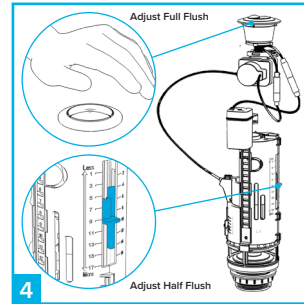

The flush volumes of the full and half flush can be adjusted. Half flush is achieved by sliding the adjustment clips down for more and up for less water. The full flush volume is adjusted using the flush button.

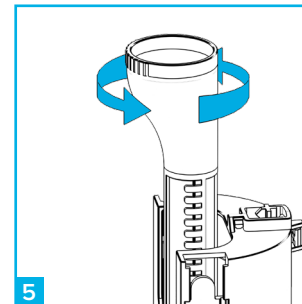

To adjust the overflow tube height, turn tube anticlockwise and adjust up and down to the correct position. Turn clockwise to lock into place.

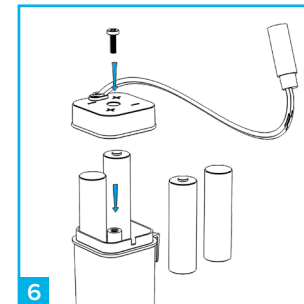

Open the battery compartment by removing the screw from the top. Insert 4x AA batteries and replace the lid, ensuring rubber seal is straight and tight.

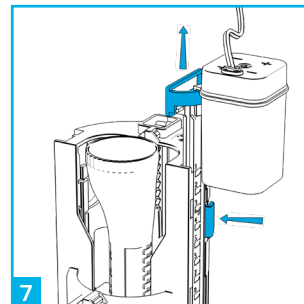

Clip battery compartment into the adjustable holder. Adjust it's height to ensure clearance from the water by pressing button and lifting the rod.

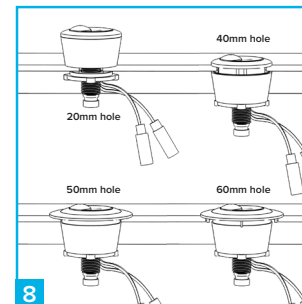

The flush valve is supplied with a universal button suitable for different cistern lid hole sizes.

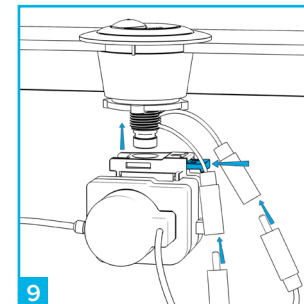

As you lower the cistern lid attach the battery and button connectors. Then connect the button box by pressing the slider and attaching to the button thread.

HOW TO OPERATE

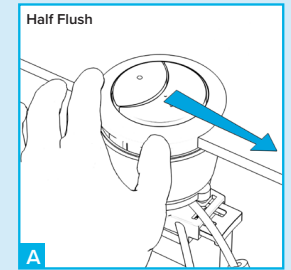

For a half flush, wave your hand across the button.

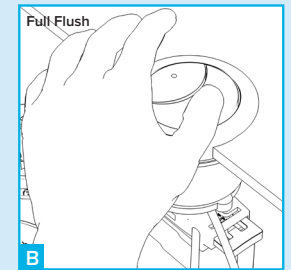

For a full flush, hold your hand over the button until the flush is initiated (more than 1.5 seconds).

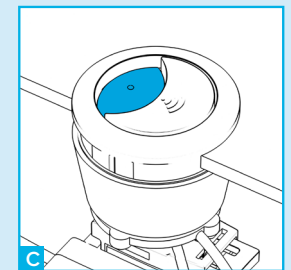

If the batteries need a replacement the flush can be temporarily activated manually by pressing the small button.

FULL FLUSH ADJUSTMENT

Enter & exit setting mode: Hold your hand over button for 15 seconds until LED flashes.

Reduce volume (0.25s):
Hold hand for one red blink then remove (confirmed by flashing LED).

Increase volume (0.25s):
Hold hand for 2 red blinks then remove (confirmed by flashing LED).

